

Section 1

Schedule 80 PVC Piping System

Effective September 27, 2010

Pipe and Fittings Sizes 1/4" to 16"



Glossary

FPT	= Female Pipe Thread
MPT	= Male Pipe Thread
S	= Tapered Socket
SPG	= Spigot End (same dimension as pipe outside diameter)
*	= Non-Returnable / Non-cancellable
^	= 40% Restocking Fee
HS	= High Strength Design
SL	= Streamline Design
BUSH	= Assembled Fitting from Molded Components
FAB	= Fabricated Fitting





Product Line	Description	Discount
46	PVC Pressure Pipe - 20 ft. Lengths Plain End	_____
48	PVC Pressure Pipe - 20 ft. Lengths Bell End	_____
08	PVC Pressure Fittings - Molded	_____
34	PVC Pressure Expansion Joint	_____
33	PVC Pressure Metal Insert Fittings	_____
02	PVC Pressure LD Fittings - Molded	_____
05	PVC Pressure LD Fittings - Fabricated	_____

The technical information given in this publication implies no warranty of any kind and is subject to change without notice. Please consult our Terms and Conditions of Sale.

For complete technical information, please consult the GF Piping Systems' Technical Manual available online at www.gfpiping.com or by calling (800) 854-4090.

For more information about any of our product lines, please call (800) 854-4090.

Schedule 80 PVC

		Page
	Schedule 80 PVC Pressure Pipe	1.5
	Schedule 80 PVC Pressure Fittings	1.6
	Schedule 80 PVC Metal Transition Fittings	1.25
	Schedule 80 PVC Expansion Joints	1.27

Specifications, Standards and Tolerances

Specifications and Standards

NSF/ANSI Standard 14

NSF/ANSI Standard 61

ASTM D 1784 : Material PVC Type I, Grade I Gray (cell classification 12454-B)

ASTM D 1785 : PVC Schedule 80 Pipe

ASTM D 2467 : PVC Schedule 80 Socket & Threaded Fittings

ASTM D 2464 : PVC Schedule 80 Threaded Fittings

ASTM F 1498 : PVC Schedule 80 Taper Threads

ASTM D 2672 : PVC Schedule 80 Tapered Sockets for Bell End Pipe

ASTM F 1970 : PVC Schedule 80 Unions

ANSI B16.5 : Outside Diameter & Flange Bolt Hole Patterns

ANSI B1.20.1 : PVC Schedule 80 NPT Threads

CSA B137.3 : PVC Schedule 80 Pipe

Molded Dimension Tolerances

A Piston Position; Expansion Joints : ± 0.03

D Outside Diameter : ± 0.06

G, G1 Intersections of centerlines to bottom of socket; 90° Ells, Tees : up to 4" ± 0.03 ; 6" and above ± 0.06

GJ, GN Intersections of centerlines to bottom of socket; 45° Wyes : up to 4" ± 0.03 ; 6" and above ± 0.06

H, HJ, HN Intersections of centerlines to face of fitting; 90° Ells, 45° Ells, Tees, 45° Wyes : up to 4" ± 0.03 ; 6" and above ± 0.06

HL Socket Bottom to Face of Fitting : up to 4" ± 0.03 ; 6" and above ± 0.06

J Intersections of centerlines to bottom of socket; 45° & 30° Ells : up to 4" ± 0.03 ; 6" and above ± 0.06

L Overall Length of fitting : ± 0.06

N Socket Bottom to Socket Bottom; Couplings, Unions : ± 0.06

N1 Socket Bottom to Face of Flange : ± 0.06

R Thickness on Plugs, Flanges : ± 0.03

T, T1 Effective Thread Length : Reference Only

W Height of Cap : ± 0.06

Fabricated Dimension Tolerances

D Outside Diameter : ± 0.50

E Drive Pin Diameter : ± 0.50

G, G1 Intersections of centerlines to bottom of socket; 90° Ells, Tees, Crosses : ± 0.25

GJ, GN Intersections of centerlines to bottom of socket; 45° Wyes : ± 0.25

H, HJ, HN Intersections of centerlines to face of fitting; 90° Ells, 45° Ells, Tees, 45° Wyes, True Wyes : ± 0.50

HL Socket Bottom to Face of Fitting : ± 0.25

J Intersections of centerlines to bottom of socket; 11¼°, 15°, 30°, 22½°, 45° Ells, True Wyes : ± 0.25

L Overall Length of fitting : ± 0.50

N Socket Bottom to Socket Bottom; Couplings : ± 0.50

N1 Socket Bottom to Face of Flange : ± 0.50

R Thickness on Plugs, Flanges : ± 0.25

T, T1 Effective Thread Length : Reference Only

W Height of Cap : ± 0.25

Schedule 80 PVC

Schedule 80 PVC Pressure Pipe

PVC80 - 20 ft. lengths

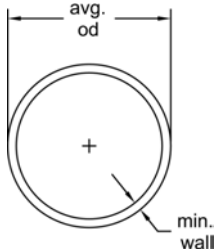

Size [inch]	Plain End (P/L 46) Part No.	USD	Bell End (P/L 48) Part No.	USD
1/2	8008-005AB *	Call	8008-005BB *	Call
3/4	8008-007AB *	Call	8008-007BB *	Call
1	8008-010AB *	Call	8008-010BB *	Call
1 1/4	8008-012AB *	Call	8008-012BB *	Call
1 1/2	8008-015AB *	Call	8008-015BB *	Call
2	8008-020AB *	Call	8008-020BB *	Call
2 1/2	8008-025AB *	Call	8008-025BB *	Call
3	8008-030AB *	Call	8008-030BB *	Call
4	8008-040AB *	Call	8008-040BB *	Call
6	8008-060AB *	Call	8008-060BB *	Call
8	8008-080AB *	Call	8008-080BB *	Call
10	8008-100AB *	Call	8008-100BB *	Call
12	8008-120AB *	Call	8008-120BB *	Call
14	8008-140AB *	Call	8008-140BB *	Call
16	8008-160AB *	Call	8008-160BB *	Call

Size [inch]	Lift Qty [ft]	Average O.D. [inch]	min. wall [inch]	A-Socket Entrance (Belled Pipe)	B-Socket Bottom (Belled Pipe)	C-Min. (Belled Pipe)
1/2	5600	0.840	0.147	0.848±0.004	0.836±0.004	1.000
3/4	5000	1.050	0.154	1.058±0.004	1.046±0.004	1.250
1	2360	1.315	0.179	1.325±0.005	1.310±0.005	1.500
1 1/4	1960	1.660	0.191	1.670±0.005	1.655±0.005	1.750
1 1/2	1800	1.900	0.200	1.912±0.006	1.894±0.006	2.000
2	1060	2.375	0.218	2.387±0.006	2.363±0.006	2.250
2 1/2	880	2.875	0.276	2.889±0.007	2.861±0.007	2.500
3	700	3.500	0.300	3.516±0.008	3.484±0.008	3.250
4	520	4.500	0.337	4.518±0.009	4.482±0.009	4.000
6	220	6.625	0.432	6.647±0.011	6.603±0.011	6.000
8	100	8.625	0.500	8.655±0.015	8.598±0.015	6.000
10	80	10.750	0.593	10.776±0.015	10.722±0.015	7.500
12	60	12.750	0.687	12.778±0.015	12.721±0.015	8.500
14	60	14.000	0.750	14.035±0.015	13.985±0.015	9.000
16	60	16.000	0.843	16.045±0.015	15.980±0.015	10.000

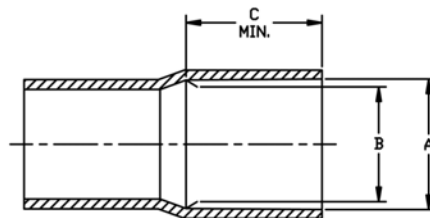

^ = 40% Restock Charge
 * = Non-Cancelable/Non-Returnable

Schedule 80 PVC

Schedule 80 PVC Pressure Fittings

Tee (S x S x S)

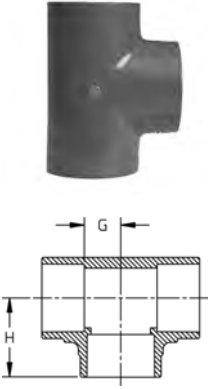

Size [inch]	P/L	Part No.	USD	Pack Qty	H [inch]	G [inch]	Design
¼	08	801-002 *	9.38	50	0.92	0.29	HS
⅜	08	801-003 *	9.38	50	1.16	0.40	HS
½	08	801-005	8.85	25	1.49	0.50	SL
¾	08	801-007	9.28	25	1.61	0.56	SL
1	08	801-010	11.61	20	1.86	0.72	SL
1 ¼	08	801-012	31.89	10	2.19	0.91	SL
1 ½	08	801-015	31.89	10	2.44	1.06	SL
2	08	801-020	39.87	10	2.78	1.29	SL
2 ½	08	801-025	43.36	5	3.33	1.50	SL
3	08	801-030	54.19	5	3.75	1.85	SL
4	08	801-040	62.79	5	4.63	2.38	SL
6	08	801-060	214.38	2	6.63	3.55	SL
8	08	801-080	497.20	1	8.70	4.59	SL
10	02	801-100	1642.65	1	10.85	5.75	SL
12	02	801-120	2319.89	1	13.00	6.81	SL
14	05	801-140N *	2463.78	1	19.50	10.88	FAB
16	05	801-160N *	3203.65	1	22.75	12.13	FAB

^ = 40% Restock Charge
 * = Non-Cancelable/Non-Returnable

Schedule 80 PVC

Reducing Tee (S x S x S)

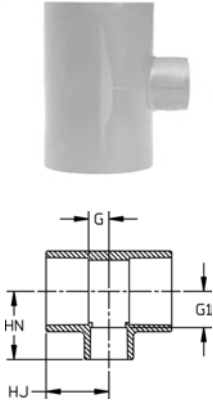

Size [inch]	P/L	Part No.	USD	Pack Qty	HJ [inch]	HN [inch]	G [inch]	G1 [inch]	Design
¾ x ½	08	801-101	6.78	25	1.63	1.63	0.61	0.73	SL
1 x ½	08	801-130	9.81	25	1.88	1.63	0.73	0.75	SL
1 x ¾	08	801-131	9.81	20	1.88	1.87	0.73	0.86	SL
1 ¼ x 1	08	801-168	21.29	20	2.00	2.00	0.73	0.91	SL
1 ½ x ½	08	801-209	21.29	5	1.91	1.93	0.54	1.05	SL
1 ½ x ¾	08	801-210	21.29	5	2.00	2.00	0.61	1.05	SL
1 ½ x 1	08	801-211	21.29	5	2.13	2.20	0.73	0.81	SL
2 x ½	08	801-247	26.98	5	2.04	2.19	0.53	1.30	SL
2 x ¾	08	801-248	26.98	5	2.13	2.31	0.73	1.29	SL
2 x 1	08	801-249	26.98	5	2.25	2.44	0.73	1.26	SL
2 x 1 ¼	08	801-250FB *	41.13	5	2.78	3.11	1.29	1.85	BUSH
2 x 1 ½	08	801-251	26.98	5	2.56	2.69	1.05	1.29	SL
2 ½ x 2	08	801-292	35.20	5	3.04	3.03	1.28	1.53	SL
3 x 2	08	801-338	49.45	5	3.21	3.40	1.31	1.87	SL
4 x 1 ½	08	801-419FB *	79.90	5	3.52	4.16	1.26	2.77	BUSH
4 x 2	08	801-420	79.90	5	3.52	3.88	1.26	2.37	SL
4 x 3	08	801-422	79.90	5	4.15	4.31	1.87	2.39	SL
6 x 2	08	801-528FB *	159.67	2	6.58	7.21	3.56	5.65	BUSH
6 x 3	08	801-530FB *	159.67	2	6.58	7.21	3.56	5.26	BUSH
6 x 4	08	801-532	214.38	2	6.58	6.81	3.49	4.50	HS
8 x 4	08	801-582FB *	580.47	1	7.63	8.09	3.59	5.84	BUSH
8 x 6	08	801-585	497.20	1	7.63	7.52	3.59	4.50	SL
10 x 2	05	801-619N *	598.12	1	9.75	12.75	4.75	11.50	FAB
10 x 3	05	801-621N *	641.48	1	10.25	12.50	5.25	11.00	FAB
10 x 4	05	801-623N *	664.55	1	10.75	11.75	5.75	9.75	FAB
10 x 6	05	801-626N *	751.57	1	11.88	12.75	6.88	9.75	FAB
10 x 6	02	801-626FB *	1445.55	1	10.85	11.98	5.75	8.88	BUSH
10 x 8	05	801-628N *	843.15	1	12.88	13.75	7.88	9.75	FAB
10 x 8	02	801-628FB *	1701.22	1	10.85	11.41	5.75	7.32	BUSH
12 x 2	05	801-659N *	773.43	1	11.00	13.75	5.00	12.50	FAB
12 x 3	05	801-661N *	833.14	1	11.50	13.50	5.50	12.00	FAB
12 x 4	05	801-663N *	883.81	1	12.00	12.75	6.00	10.75	FAB
12 x 6	05	801-666N *	975.90	1	13.13	13.75	7.13	10.75	FAB
12 x 8	05	801-668N *	1047.00	1	14.13	14.75	8.13	10.75	FAB
12 x 8	02	801-668FB *	2150.55	1	13.00	13.69	6.81	9.25	BUSH
12 x 10	05	801-670N *	1163.45	1	15.13	16.75	9.13	10.75	FAB
12 x 10	02	801-670FB *	2879.88	1	13.00	13.53	6.81	8.44	BUSH
14 x 2	05	801-692N *	969.10	1	12.13	14.50	5.13	13.13	FAB
14 x 3	05	801-694N *	1189.78	1	12.63	14.25	5.63	12.75	FAB
14 x 4	05	801-696N *	1311.15	1	13.13	13.50	6.13	11.50	FAB
14 x 6	05	801-698N *	1415.39	1	14.25	14.50	7.25	11.50	FAB
14 x 8	05	801-700N *	1488.36	1	15.25	15.50	8.25	11.50	FAB
14 x 10	05	801-702N *	1590.06	1	16.25	16.50	9.25	11.50	FAB
14 x 12	05	801-704N *	1679.01	1	17.25	18.50	10.25	12.50	FAB
16 x 2	05	801-726N *	1242.72	1	13.38	12.75	5.38	11.50	FAB
16 x 3	05	801-728N *	1340.74	1	13.88	13.75	5.88	12.25	FAB
16 x 4	05	801-730N *	1466.83	1	14.38	14.75	6.38	12.75	FAB
16 x 6	05	801-732N *	1560.47	1	15.50	15.75	7.50	12.75	FAB
16 x 8	05	801-734N *	1733.22	1	16.50	16.75	8.50	12.75	FAB
16 x 10	05	801-736N *	1878.82	1	17.50	17.75	9.50	12.75	FAB
16 x 12	05	801-738N *	2070.52	1	18.50	19.75	10.50	13.75	FAB
16 x 14	05	801-740N *	2387.48	1	19.13	20.75	11.13	13.75	FAB

^ = 40% Restock Charge

* = Non-Cancelable/Non-Returnable

+GF+

Schedule 80 PVC

Tee (S x S x FPT)

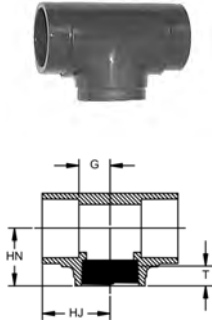

Size [inch]	P/L	Part No.	USD	Pack Qty	HJ [inch]	HN [inch]	G [inch]	T [inch]	Design
½	08	802-005	14.00	25	1.39	1.39	0.52	0.53	HS
¾	08	802-007	18.12	25	1.58	1.37	0.58	0.55	HS
1	08	802-010	21.20	15	1.83	1.70	0.70	0.68	HS
1 ½	08	802-015	26.63	5	2.42	2.08	1.03	0.72	HS
2	08	802-020	32.84	5	2.79	2.35	1.28	0.76	HS

Tee (FPT x FPT x FPT)

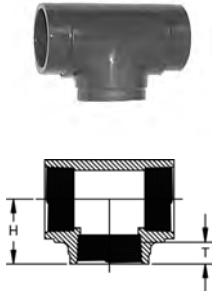

Size [inch]	P/L	Part No.	USD	Pack Qty	H [inch]	T [inch]	Design
¼	08	805-002 *	10.82	50	0.92	0.40	HS
⅜	08	805-003 *	10.82	50	1.16	0.41	HS
½	08	805-005 ^	10.23	25	1.27	0.53	HS
¾	08	805-007 ^	11.39	25	1.38	0.55	HS
1	08	805-010 ^	25.15	15	1.70	0.68	HS
1 ¼	08	805-012 ^	26.66	10	1.93	0.71	HS
1 ½	08	805-015 ^	32.32	5	2.08	0.72	HS
2	08	805-020 ^	34.74	5	2.35	0.76	HS
2 ½	08	805-025 ^	126.49	5	2.88	1.14	HS
3	08	805-030 ^	132.11	5	3.50	1.20	HS
4	08	805-040 ^	214.70	5	4.06	1.30	HS

90° Ell (S x S)

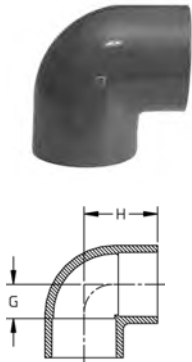

Size [inch]	P/L	Part No.	USD	Pack Qty	H [inch]	G [inch]	Design
¼	08	806-002 *	3.33	50	0.95	0.33	HS
⅜	08	806-003 *	3.33	50	1.17	0.41	HS
½	08	806-005	3.14	25	1.41	0.50	SL
¾	08	806-007	4.01	25	1.61	0.56	SL
1	08	806-010	6.46	10	1.86	0.69	SL
1 ¼	08	806-012	8.65	10	2.16	0.91	SL
1 ½	08	806-015	9.27	10	2.41	1.03	SL
2	08	806-020	11.20	20	2.78	1.28	SL
2 ½	08	806-025	26.21	5	3.29	1.53	SL
3	08	806-030	29.46	5	3.75	1.85	SL
4	08	806-040	44.80	5	4.60	2.34	SL
6	08	806-060	127.48	2	6.70	3.69	SL
8	08	806-080	351.37	1	8.67	4.59	SL
10	02	806-100	1572.50	1	10.75	5.75	SL
12	02	806-120	2049.86	1	12.63	6.06	SL
14	05	806-140N *	1308.48	1	26.25	19.25	FAB
16	05	806-160N *	1627.33	1	30.00	22.00	FAB

^ = 40% Restock Charge
* = Non-Cancelable/Non-Returnable

Schedule 80 PVC

90° EII (S x FPT)

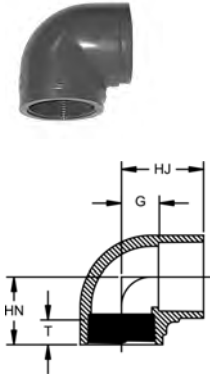

Size [inch]	P/L	Part No.	USD	Pack Qty	HJ [inch]	HN [inch]	G [inch]	T [inch]	Design
1/2	08	807-005	12.35	25	1.80	1.28	0.50	0.53	HS
3/4	08	807-007	14.53	25	1.57	1.38	0.56	0.55	HS
1	08	807-010	15.71	10	1.82	1.70	0.69	0.68	HS
1 1/4	08	807-012	18.12	10	2.16	1.93	0.91	0.71	HS
1 1/2	08	807-015	21.61	10	2.41	2.07	1.03	0.72	HS
2	08	807-020	28.00	5	2.78	2.35	1.28	0.76	HS
3	08	807-030	66.87	5	3.75	3.50	1.85	1.20	HS

90° EII (FPT x FPT)

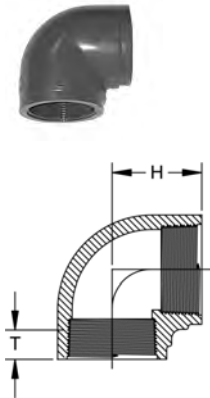

Size [inch]	P/L	Part No.	USD	Pack Qty	H [inch]	T [inch]	Design
1/4	08	808-002 *	8.24	50	0.92	0.40	HS
3/8	08	808-003 *	8.24	50	1.00	0.41	HS
1/2	08	808-005 ^	7.27	25	1.29	0.53	HS
3/4	08	808-007 ^	9.05	25	1.38	0.55	HS
1	08	808-010 ^	11.39	10	1.70	0.68	HS
1 1/4	08	808-012 ^	12.27	10	1.93	0.71	HS
1 1/2	08	808-015 ^	17.40	10	2.06	0.72	HS
2	08	808-020 ^	19.61	5	2.36	0.76	HS
2 1/2	08	808-025 ^	76.35	5	3.00	1.14	HS
3	08	808-030 ^	123.12	5	3.50	1.20	HS
4	08	808-040 ^	216.64	5	4.13	1.30	HS

45° EII (S x S)

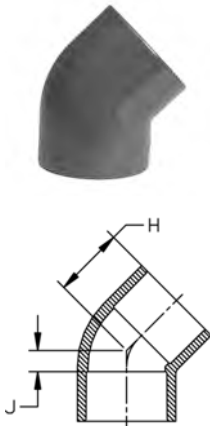

Size [inch]	P/L	Part No.	USD	Pack Qty	H [inch]	J [inch]	Design
1/4	08	817-002 *	11.90	50	0.81	0.13	HS
3/8	08	817-003 *	11.90	50	0.94	0.19	HS
1/2	08	817-005	5.91	25	1.21	0.25	SL
3/4	08	817-007	9.03	20	1.32	0.33	SL
1	08	817-010	13.54	25	1.47	0.29	SL
1 1/4	08	817-012	17.24	15	1.70	0.40	SL
1 1/2	08	817-015	20.39	10	1.88	0.44	SL
2	08	817-020	26.44	5	2.16	0.60	SL
2 1/2	08	817-025	55.50	5	2.53	0.76	SL
3	08	817-030	67.55	5	2.66	0.78	SL
4	08	817-040	121.65	5	3.24	0.95	SL
6	08	817-060	153.20	2	4.81	1.74	SL
8	08	817-080	332.15	2	6.11	2.02	SL
10	02	817-100	1045.71	1	7.50	2.50	SL
12	02	817-120	1348.90	1	9.00	3.00	SL
14	05	817-140N *	1012.01	1	10.50	3.50	FAB
16	05	817-160N *	1238.94	1	11.75	3.75	FAB

^ = 40% Restock Charge

* = Non-Cancelable/Non-Returnable

+GF+

Schedule 80 PVC

45° EII (FPT x FPT)

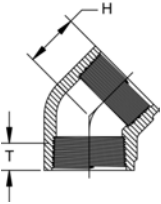

Size [inch]	P/L	Part No.	USD	Pack Qty	H [inch]	T [inch]	Design
¼	08	819-002 *	13.51	50	0.76	0.40	HS
⅜	08	819-003 *	13.51	50	0.94	0.41	HS
½	08	819-005 ^	11.67	25	1.02	0.53	HS
¾	08	819-007 ^	12.54	20	1.14	0.55	HS
1	08	819-010 ^	15.73	25	1.33	0.68	HS
1 ¼	08	819-012 ^	24.00	15	1.40	0.71	HS
1 ½	08	819-015 ^	30.17	10	1.52	0.72	HS
2	08	819-020 ^	44.73	5	1.72	0.76	HS
3	08	819-030 ^	142.35	5	2.44	1.20	HS
4	08	819-040 ^	204.26	5	2.77	1.30	HS

Coupling (S x S)

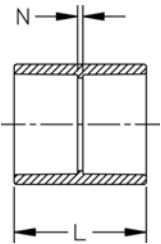

Size [inch]	P/L	Part No.	USD	Pack Qty	L [inch]	N [inch]	Design
¼	08	829-002 *	9.60	50	1.39	0.14	HS
⅜	08	829-003 *	9.60	50	1.64	0.14	HS
½	08	829-005	5.68	25	1.93	0.13	SL
¾	08	829-007	7.69	20	2.18	0.13	SL
1	08	829-010	7.90	25	2.41	0.13	SL
1 ¼	08	829-012	12.04	10	2.64	0.12	SL
1 ½	08	829-015	12.98	10	2.90	0.13	SL
2	08	829-020	13.94	20	3.14	0.12	SL
2 ½	08	829-025	34.30	5	3.75	0.16	SL
3	08	829-030	39.39	5	4.05	0.25	SL
4	08	829-040	49.33	5	4.79	0.25	SL
6	08	829-060	106.17	2	6.41	0.34	SL
8	08	829-080	144.49	2	8.40	0.34	SL
10	02	829-100	495.91	2	10.55	0.49	SL
12	02	829-120	571.53	1	12.54	0.50	SL
14	05	829-140N *	384.95	1	16.75	2.75	FAB
16	05	829-160N *	457.66	1	19.00	3.00	FAB

^ = 40% Restock Charge
* = Non-Cancelable/Non-Returnable

Schedule 80 PVC

Reducing Coupling (S x S)

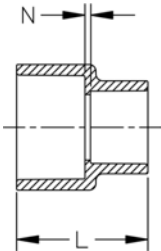
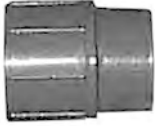

Size [inch]	P/L	Part No.	USD	Pack Qty	L [inch]	N [inch]	Design
¾ x ½	08	829-101	6.95	20	2.16	0.14	HS
1 x ½	08	829-130	9.71	25	2.12	0.09	HS
1 x ¾	08	829-131	10.14	25	2.26	0.12	HS
1 ¼ x 1	08	829-168	20.59	10	2.54	0.09	HS
1 ½ x ½	08	829-209FB *	21.55	10	3.34	0.17	BUSH
1 ½ x ¾	08	829-210	21.55	10	3.34	0.17	BUSH
1 ½ x 1	08	829-211	21.55	10	2.66	0.10	HS
1 ½ x 1 ¼	08	829-212	26.63	10	2.82	0.10	HS
2 x ½	08	829-247FB *	24.30	5	3.35	0.88	BUSH
2 x ¾	08	829-248FB *	24.30	5	3.36	0.77	BUSH
2 x 1	08	829-249	24.30	5	3.12	0.33	HS
2 x 1 ¼	08	829-250	24.30	5	3.00	0.13	HS
2 x 1 ½	08	829-251	24.30	5	3.05	0.10	HS
2 ½ x 1 ½	08	829-291	32.41	5	3.30	0.13	HS
2 ½ x 2	08	829-292FB *	32.41	5	4.00	0.65	BUSH
3 x 1 ½	08	829-337FB *	74.12	5	4.55	1.16	BUSH
3 x 2	08	829-338	59.69	5	3.61	0.16	HS
3 x 2 ½	08	829-339FB *	85.11	5	4.49	0.76	BUSH
4 x 2	08	829-420FB *	113.79	5	4.94	1.12	BUSH
4 x 3	08	829-422	112.45	5	4.39	0.26	HS
6 x 4	08	829-532	229.36	2	10.25	3.50	HS
8 x 4	08	829-582FB *	251.22	2	9.77	3.42	BUSH
8 x 6	08	829-585	694.67	2	9.26	2.07	HS
10 x 4	05	829-623N *	382.88	1	17.50	10.50	FAB
10 x 6	05	829-626N *	313.77	1	13.25	5.25	FAB
10 x 6	02	829-626FB *	813.26	1	10.96	2.90	BUSH
10 x 8	05	829-628N *	225.83	1	12.75	3.75	FAB
10 x 8	02	829-628FB *	813.26	2	11.18	2.07	BUSH
12 x 8	05	829-668N *	357.87	1	15.50	5.50	FAB
12 x 8	02	829-668FB *	925.41	1	13.40	2.97	BUSH
12 x 10	05	829-670N *	241.77	1	15.00	4.00	FAB
12 x 10	02	829-670FB *	937.27	1	13.24	2.13	BUSH
14 x 10	05	829-702N *	588.52	1	17.00	5.00	FAB
14 x 12	05	829-704N *	352.99	1	16.50	3.50	FAB
16 x 12	05	829-738N *	687.41	1	19.25	5.25	FAB
16 x 14	05	829-740N *	521.83	1	19.50	4.50	FAB

Coupling (FPT x FPT)

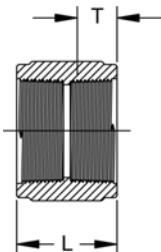

Size [inch]	P/L	Part No.	USD	Pack Qty	L [inch]	T [inch]	Design
¼	08	830-002 *	7.26	50	1.30	0.40	HS
⅜	08	830-003 *	7.26	50	1.34	0.41	HS
½	08	830-005 ^	6.36	25	1.66	0.53	HS
¾	08	830-007 ^	9.06	20	1.73	0.55	HS
1	08	830-010 ^	9.73	25	2.10	0.68	HS
1 ¼	08	830-012 ^	12.04	10	2.19	0.71	HS
1 ½	08	830-015 ^	26.79	10	2.22	0.72	HS
2	08	830-020 ^	28.12	5	2.29	0.76	HS
2 ½	08	830-025 ^	67.13	5	3.39	1.14	HS
3	08	830-030 ^	78.72	5	3.57	1.20	HS
4	08	830-040 ^	136.31	5	3.73	1.30	HS

^ = 40% Restock Charge

* = Non-Cancelable/Non-Returnable

+GF+

Schedule 80 PVC

Reducing Coupling (FPT x FPT)

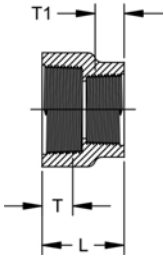

Size [inch]	P/L	Part No.	USD	Pack Qty	L [inch]	T [inch]	T1 [inch]	Design
3/8 x 1/4	08	830-052 *	10.50	50	1.29	0.41	0.40	HS
1/2 x 1/4	08	830-072 *	10.75	50	1.45	0.53	0.40	HS
1/2 x 3/8	08	830-073 *	10.96	50	1.46	0.53	0.41	HS
3/4 x 1/2	08	830-101 ^	7.56	25	1.69	0.55	0.53	HS
1 x 1/2	08	830-130 ^	11.20	25	1.83	0.68	0.53	HS
1 x 3/4	08	830-131 ^	11.20	25	1.88	0.68	0.55	HS
1 1/4 x 3/4	08	830-167 ^	24.09	25	1.91	0.71	0.55	HS
1 1/2 x 1	08	830-211 ^	36.86	20	2.11	0.72	0.68	HS
2 x 1 1/2	08	830-251 ^	47.42	10	2.11	0.76	0.72	HS

Female Adapter (S x FPT)

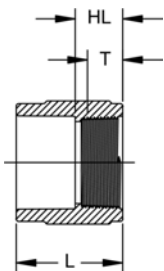

Size [inch]	P/L	Part No.	USD	Pack Qty	HL [inch]	L [inch]	T [inch]	Design
1/4	08	835-002 *	10.21	50	0.75	1.43	0.40	HS
3/8	08	835-003 *	10.21	50	0.75	1.55	0.41	HS
1/2	08	835-005	5.32	25	0.91	1.79	0.53	HS
3/4	08	835-007	7.90	25	0.95	1.96	0.55	HS
1	08	835-010	11.65	25	1.11	2.26	0.68	HS
1 1/4	08	835-012	18.87	10	1.16	2.44	0.71	HS
1 1/2	08	835-015	23.13	10	1.19	2.58	0.72	HS
2	08	835-020	40.36	10	1.23	2.74	0.76	HS
2 1/2	08	835-025	63.72	5	1.75	3.50	1.14	HS
3	08	835-030	71.73	5	1.91	3.82	1.20	HS
4	08	835-040	123.28	5	2.02	4.29	1.30	HS
6	05	835-060N *	191.69	1	4.75	7.75	1.50	FAB
8	05	835-080N *	226.60	1	5.00	9.00	1.75	FAB
10	05	835-100N *	248.38	1	4.50	9.50	2.00	FAB
12	05	835-120N *	313.46	1	4.50	10.50	2.13	FAB

Male Adapter (S x MPT)

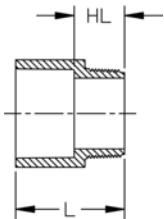

Size [inch]	P/L	Part No.	USD	Pack Qty	HL [inch]	L [inch]	Design
1/2	08	836-005	6.64	50	0.93	1.86	SL
3/4	08	836-007	7.32	25	1.00	2.04	HS
1	08	836-010	12.67	25	1.21	2.39	HS
1 1/4	08	836-012	14.82	15	1.29	2.56	HS
1 1/2	08	836-015	21.29	10	1.32	2.72	HS
2	08	836-020	30.79	5	1.35	2.88	HS
2 1/2	08	836-025	35.00	5	1.87	3.68	HS
3	08	836-030	38.85	5	2.02	3.92	HS
4	08	836-040	69.12	5	2.08	4.40	HS
6	05	836-060N *	153.54	1	3.63	6.63	FAB
8	05	836-080N *	165.55	1	3.50	7.50	FAB
10	05	836-100N *	198.13	1	4.25	9.25	FAB
12	05	836-120N *	294.44	1	4.25	10.25	FAB

^ = 40% Restock Charge
* = Non-Cancelable/Non-Returnable

Schedule 80 PVC

Flush Style Reducer Bushing (SPG x S)

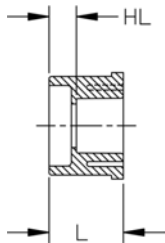

Size [inch]	P/L	Part No.	USD	Pack Qty	HL [inch]	L [inch]	Design
1/2 x 1/4	08	837-072 *	5.34	50	0.46	1.14	FLUSH
1/2 x 3/8	08	837-073 *	5.34	50	0.32	1.10	FLUSH
3/4 x 1/2	08	837-101	1.83	50	0.40	1.29	FLUSH
1 x 1/2	08	837-130	5.24	25	0.54	1.42	FLUSH
1 x 3/4	08	837-131	5.24	50	0.44	1.42	FLUSH
1 1/4 x 1/2	08	837-166	8.22	25	0.66	1.56	FLUSH
1 1/4 x 3/4	08	837-167	8.22	25	0.55	1.57	FLUSH
1 1/4 x 1	08	837-168	8.22	25	0.42	1.57	FLUSH
1 1/2 x 1/2	08	837-209	11.20	25	0.77	1.68	FLUSH
1 1/2 x 3/4	08	837-210	11.20	25	0.67	1.69	FLUSH
1 1/2 x 1	08	837-211	11.20	25	0.55	1.68	FLUSH
1 1/2 x 1 1/4	08	837-212	11.20	25	0.42	1.70	FLUSH
2 x 1/2	08	837-247	15.97	10	0.88	1.79	FLUSH
2 x 3/4	08	837-248	15.97	10	0.78	1.81	FLUSH
2 x 1	08	837-249	15.97	10	0.66	1.81	FLUSH
2 x 1 1/4	08	837-250	15.97	10	0.56	1.82	FLUSH
2 x 1 1/2	08	837-251	15.97	10	0.40	1.80	FLUSH
2 1/2 x 1 1/2	08	837-291	27.73	5	0.96	2.43	FLUSH
2 1/2 x 2	08	837-292	27.73	5	0.55	2.13	FLUSH
3 x 1	08	837-335FB *	43.99	5	1.53	3.09	BUSH
3 x 1 1/4	08	837-336FB *	43.99	5	1.45	2.72	BUSH
3 x 1 1/2	08	837-337	43.99	5	0.92	2.43	FLUSH
3 x 2	08	837-338	43.99	5	0.87	2.43	FLUSH
3 x 2 1/2	08	837-339	43.99	5	0.39	2.23	FLUSH
4 x 2	08	837-420	60.91	5	1.15	2.72	FLUSH
4 x 3	08	837-422	60.91	5	0.77	2.76	FLUSH
6 x 3	08	837-530	84.70	2	1.41	3.66	FLUSH
6 x 4	08	837-532	84.70	2	1.13	3.66	FLUSH
8 x 6	08	837-585	206.05	2	1.56	4.66	FLUSH
10 x 4	02	837-623FB *	573.68	1	3.91	6.16	BUSH
10 x 4	05	837-623N *	403.90	1	3.75	6.00	FAB
10 x 6	02	837-626	484.03	1	2.57	5.66	FLUSH
10 x 8	02	837-628	484.03	1	1.57	5.66	FLUSH
12 x 6	02	837-666FB *	781.05	1	4.19	7.29	BUSH
12 x 6	05	837-666N *	549.90	1	3.00	6.50	FAB
12 x 8	02	837-668	559.38	1	2.63	6.72	FLUSH
12 x 10	02	837-670	559.38	1	1.63	6.72	FLUSH
14 x 4	05	837-696N *	1212.28	1	5.00	7.50	FAB
14 x 6	05	837-698N *	1079.40	1	4.00	7.50	FAB
14 x 8	05	837-700N *	773.38	1	3.00	7.50	FAB
14 x 10	05	837-702N *	482.81	1	2.00	7.50	FAB
14 x 12	05	837-704N *	207.12	1	1.00	7.50	FAB
16 x 4	05	837-730N *	1384.90	1	6.00	8.50	FAB
16 x 6	05	837-732N *	1286.00	1	5.00	8.50	FAB
16 x 8	05	837-734N *	1012.49	1	4.00	8.50	FAB
16 x 10	05	837-736N *	733.88	1	3.00	8.50	FAB
16 x 12	05	837-738N *	433.13	1	2.00	8.50	FAB
16 x 14	05	837-740N *	423.12	1	1.00	8.50	FAB

^ = 40% Restock Charge

* = Non-Cancelable/Non-Returnable

+GF+

Schedule 80 PVC

Flush Style Reducer Bushing (SPG x FPT)

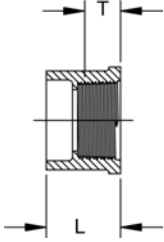

Size [inch]	P/L	Part No.	USD	Pack Qty	L [inch]	T [inch]	Design
3/8 x 1/4	08	838-052E *	5.34	50	0.98	0.40	Extended
1/2 x 1/4	08	838-072 *	5.34	50	1.14	0.40	FLUSH
1/2 x 3/8	08	838-073 *	5.34	50	1.12	0.41	FLUSH
3/4 x 1/4	08	838-098 *	3.32	50	1.21	0.40	FLUSH
3/4 x 1/2	08	838-101	3.32	50	1.28	0.53	FLUSH
1 x 1/2	08	838-130	5.24	50	1.42	0.53	FLUSH
1 x 3/4	08	838-131	5.24	50	1.41	0.55	FLUSH
1 1/4 x 1/2	08	838-166	10.65	15	1.53	0.53	FLUSH
1 1/4 x 3/4	08	838-167	10.65	15	1.56	0.55	FLUSH
1 1/4 x 1	08	838-168	10.65	15	1.55	0.68	FLUSH
1 1/2 x 1/2	08	838-209	13.34	15	1.68	0.53	FLUSH
1 1/2 x 3/4	08	838-210	13.34	15	1.68	0.55	FLUSH
1 1/2 x 1	08	838-211	13.34	15	1.69	0.68	FLUSH
1 1/2 x 1 1/4	08	838-212	13.34	15	1.68	0.71	FLUSH
2 x 1/2	08	838-247	16.32	10	1.80	0.53	FLUSH
2 x 3/4	08	838-248	16.32	10	1.80	0.55	FLUSH
2 x 1	08	838-249	16.32	10	1.79	0.68	FLUSH
2 x 1 1/4	08	838-250	16.32	10	1.78	0.71	FLUSH
2 x 1 1/2	08	838-251	16.32	10	1.79	0.72	FLUSH
2 1/2 x 1 1/2	08	838-291	34.55	5	2.11	0.72	FLUSH
2 1/2 x 2	08	838-292	34.55	5	2.20	0.76	FLUSH
3 x 2	08	838-338	63.96	5	2.44	0.76	FLUSH
3 x 2 1/2	08	838-339	63.96	5	2.20	1.14	FLUSH
4 x 2	08	838-420	98.26	5	2.73	0.76	FLUSH
4 x 3	08	838-422	98.26	5	2.69	1.20	FLUSH

Flush Style Reducer Bushing (MPT x FPT)

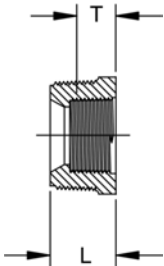

Size [inch]	P/L	Part No.	USD	Pack Qty	L [inch]	T [inch]	Style
3/8 x 1/4	08	839-052 *	12.36	50	0.79	0.40	FLUSH
1/2 x 1/4	08	839-072 *	12.36	50	0.96	0.40	FLUSH
1/2 x 3/8	08	839-073 *	12.36	50	0.94	0.40	FLUSH
3/4 x 1/4	08	839-098 *	8.53	50	1.02	0.40	FLUSH
3/4 x 3/8	08	839-099 *	8.53	50	1.02	0.41	FLUSH
3/4 x 1/2	08	839-101 ^	7.03	50	1.08	0.53	FLUSH
1 x 1/4	08	839-128 ^	13.77	25	1.22	0.40	FLUSH
1 x 1/2	08	839-130 ^	11.01	25	1.24	0.53	FLUSH
1 x 3/4	08	839-131 ^	11.01	25	1.27	0.55	FLUSH
1 1/4 x 1/2	08	839-166 ^	11.68	25	12.83	0.53	FLUSH
1 1/4 x 3/4	08	839-167 ^	11.68	25	1.29	0.55	FLUSH
1 1/4 x 1	08	839-168 ^	11.68	25	1.30	0.68	FLUSH
1 1/2 x 3/4	08	839-210 ^	13.84	25	1.33	0.55	FLUSH
1 1/2 x 1	08	839-211 ^	13.84	25	1.34	0.68	FLUSH
1 1/2 x 1 1/4	08	839-212 ^	13.84	25	1.32	0.71	FLUSH
2 x 1/2	08	839-247 ^	20.28	10	1.43	0.53	FLUSH
2 x 3/4	08	839-248 ^	20.28	10	1.43	0.55	FLUSH
2 x 1	08	839-249 ^	20.28	10	1.43	0.68	FLUSH
2 x 1 1/4	08	839-250 ^	20.28	10	1.43	0.71	FLUSH
2 x 1 1/2	08	839-251 ^	20.28	10	1.35	0.72	FLUSH
3 x 2	08	839-338 ^	37.33	5	2.03	0.76	FLUSH
4 x 2	08	839-420 ^	76.94	5	2.06	0.76	FLUSH
4 x 3	08	839-422 ^	98.26	5	2.06	1.20	FLUSH

^ = 40% Restock Charge
* = Non-Cancelable/Non-Returnable

Schedule 80 PVC

Cap (S)

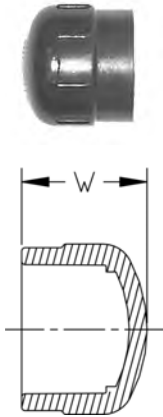

Size [inch]	P/L	Part No.	USD	Pack Qty	W [inch]	Design
1/4	08	847-002 *	7.62	50	0.95	HS
3/8	08	847-003 *	7.62	50	1.09	HS
1/2	08	847-005	5.56	50	1.29	HS
3/4	08	847-007	5.86	50	1.46	HS
1	08	847-010	10.41	25	1.67	HS
1 1/4	08	847-012	12.56	15	1.88	HS
1 1/2	08	847-015	12.56	10	2.09	HS
2	08	847-020	24.80	5	2.32	HS
2 1/2	08	847-025	50.64	5	2.73	HS
3	08	847-030	59.26	5	3.05	HS
4	08	847-040	99.93	5	3.67	HS
6	08	847-060	248.60	2	4.96	HS
8	08	847-080	319.18	2	6.29	SL
10	02	847-100	326.50	1	7.88	SL
12	02	847-120	490.00	1	9.38	SL
14	05	847-140N *	542.65	1	5.75	FAB
16	05	847-160N *	703.00	1	7.50	FAB

Cap (FPT)

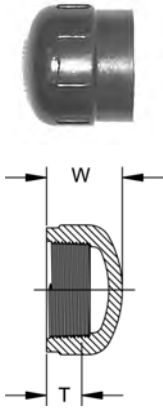

Size [inch]	P/L	Part No.	USD	Pack Qty	W [inch]	T [inch]	Design
1/4	08	848-002 *	7.34	50	0.93	0.40	HS
3/8	08	848-003 *	7.34	50	0.95	0.41	HS
1/2	08	848-005 ^	6.95	50	1.16	0.53	HS
3/4	08	848-007 ^	7.79	25	1.24	0.55	HS
1	08	848-010 ^	9.81	25	1.50	0.68	HS
1 1/4	08	848-012 ^	11.68	15	1.61	0.71	HS
1 1/2	08	848-015 ^	13.34	10	1.66	0.72	HS
2	08	848-020 ^	26.21	5	1.84	0.76	HS
2 1/2	08	848-025 ^	52.43	5	2.56	1.14	HS
3	08	848-030 ^	61.72	5	2.83	1.20	HS
4	08	848-040 ^	108.68	5	3.13	1.30	HS

Plug (SPG)

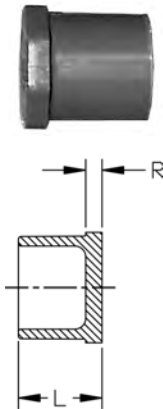

Size [inch]	P/L	Part No.	USD	Pack Qty	L [inch]	R [inch]
1/2	08	849-005	5.20	50	1.09	0.20
3/4	08	849-007	5.79	50	1.26	0.23
1	08	849-010	6.53	25	1.41	0.25
1 1/2	08	849-015	9.14	20	1.71	0.31
2	08	849-020	12.09	10	1.90	0.38
4	08	849-040	74.68	5	2.64	0.39

^ = 40% Restock Charge

* = Non-Cancelable/Non-Returnable

+GF+

Schedule 80 PVC

Plug (MPT)

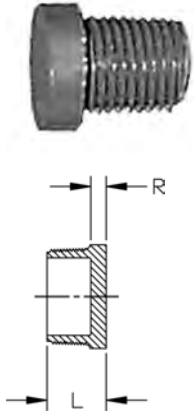

Size [inch]	P/L	Part No.	USD	Pack Qty	L [inch]	R [inch]
1/4	08	850-002 *	6.35	50	0.81	0.22
3/8	08	850-003 *	6.35	50	0.83	0.22
1/2	08	850-005	5.35	50	0.97	0.22
3/4	08	850-007	5.56	50	1.04	0.25
1	08	850-010	6.81	25	1.25	0.27
1 1/4	08	850-012	10.04	25	1.32	0.31
1 1/2	08	850-015	12.21	20	1.38	0.34
2	08	850-020	12.54	10	1.46	0.40
2 1/2	08	850-025	35.00	10	2.00	0.38
3	08	850-030	40.84	5	2.00	0.38
4	08	850-040	79.51	5	2.15	0.39
6	05	850-060H *	94.52	1	4.00	1.00
8	05	850-080H *	366.06	1	4.00	1.00
10	05	850-100H *	447.47	1	4.00	1.00
12	05	850-120H *	504.37	1	4.00	1.00

Flange - One Piece (S)

150 psi @ 73°F (10.3 bar @ 22.7°C)

HC = Honeycomb (Front)

WEB = Webbed (Back)



Size [inch]	P/L	Part No.	USD
1/2	08	851-005	17.20
3/4	08	851-007	18.38
1	08	851-010	20.47
1 1/4	08	851-012	21.09
1 1/2	08	851-015	21.55
2	08	851-020	28.68
2 1/2	08	851-025	44.27
3	08	851-030	48.89
4	08	851-040	61.90
6	08	851-060	97.33
8	08	851-080	174.16

Size [inch]	Pack Qty	# holes	Bolt Dia. [inch]	bolt cir. dia. [inch]	D [inch]	L [inch]	N1 [inch]	R [inch]	Design
1/2	5	4	1/2	2.38	3.50	1.03	0.15	0.44	SOLID
3/4	5	4	1/2	2.75	3.88	1.21	0.19	0.51	SOLID
1	5	4	1/2	3.13	4.25	1.39	0.13	0.55	HC
1 1/4	5	4	1/2	3.50	4.63	1.42	0.16	0.62	HC
1 1/2	5	4	1/2	3.88	5.00	1.54	0.16	0.72	HC
2	5	4	5/8	4.75	6.00	1.77	0.16	0.75	HC
2 1/2	5	4	5/8	5.50	7.00	2.01	0.19	0.80	HC
3	5	4	5/8	6.00	7.50	2.20	0.31	0.98	WEB
4	5	8	5/8	7.50	9.00	2.55	0.22	1.24	WEB
6	2	8	3/4	9.50	11.00	3.86	0.34	1.32	HC
8	2	8	3/4	11.75	13.50	4.85	0.35	1.37	HC

^ = 40% Restock Charge
* = Non-Cancelable/Non-Returnable

Schedule 80 PVC

Flange - One Piece (FPT)

150 psi @ 73°F (10.3 bar @ 22.7°C)

HC = Honeycomb (Front)

WEB = Webbed (Back)

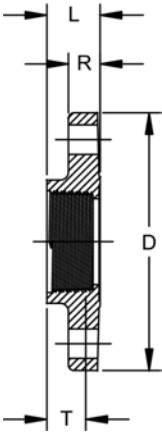

Size [inch]	P/L	Part No.	USD
1/2	08	852-005 ^	20.59
3/4	08	852-007 ^	24.12
1	08	852-010 ^	26.41
1 1/4	08	852-012 ^	36.41
1 1/2	08	852-015 ^	39.74
2	08	852-020 ^	40.64
2 1/2	08	852-025 ^	93.44
3	08	852-030 ^	96.18
4	08	852-040 ^	180.71

Size [inch]	Pack Qty	# holes	Bolt Dia. [inch]	bolt cir. dia. [inch]	D [inch]	L [inch]	T [inch]	R [inch]	Design
1/2	5	4	1/2	2.38	3.50	0.94	0.53	0.44	SOLID
3/4	5	4	1/2	2.75	3.88	0.95	0.55	0.51	SOLID
1	5	4	1/2	3.13	4.25	1.13	0.68	0.55	HC
1 1/4	5	4	1/2	3.50	4.63	1.19	0.71	0.63	HC
1 1/2	5	4	1/2	3.88	5.00	1.21	0.72	0.72	HC
2	5	4	5/8	4.75	6.00	1.23	0.76	0.75	HC
2 1/2	5	4	5/8	5.50	7.00	1.23	1.14	0.80	HC
3	5	4	5/8	6.00	7.50	1.88	1.20	0.98	WEB
4	5	8	5/8	7.50	9.00	1.99	1.30	1.24	WEB

Flange (Blind)

150 psi @ 73°F (10.3 bar @ 22.7°C)

HC = Honeycomb (Front)

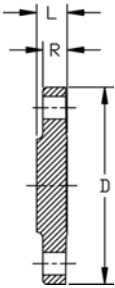

Size [inch]	P/L	Part No.	USD	Pack Qty	# holes	Bolt Dia. [inch]	bolt cir. dia. [inch]	D [inch]	L [inch]	R [inch]	Design
1/2	08	853-005	24.11	5	4	1/2	2.38	3.50	0.50	0.43	HC
3/4	08	853-007	28.72	5	4	1/2	2.75	3.88	0.50	0.44	HC
1	08	853-010	39.23	5	4	1/2	3.13	4.25	0.60	0.57	HC
1 1/4	08	853-012	48.15	5	4	1/2	3.50	4.63	0.63	0.56	HC
1 1/2	08	853-015	48.15	5	4	1/2	3.88	5.00	0.82	0.71	HC
2	08	853-020	71.94	5	4	5/8	4.75	6.00	0.92	0.74	HC
2 1/2	08	853-025	117.21	5	4	5/8	5.50	7.00	0.96	0.78	HC
3	08	853-030	141.45	5	4	5/8	6.00	7.50	1.03	0.89	HC
4	08	853-040	176.21	5	8	5/8	7.50	9.00	1.35	1.12	HC
6	08	853-060	214.13	2	8	3/4	9.50	11.00	1.49	1.27	HC
8	08	853-080	268.02	2	8	3/4	11.75	13.50	1.63	1.45	HC
10	05	853-100N *	448.18	1	12	1	14.25	16.00	1.00	1.00	SOLID
12	05	853-120N *	698.01	1	12	1	17.00	19.00	1.00	1.00	SOLID
14	05	853-140N *	1327.90	1	12	1 1/8	18.75	21.00	1.00	1.00	SOLID
16	05	853-160N *	1574.63	1	16	1 1/8	21.25	23.50	1.00	1.00	SOLID

^ = 40% Restock Charge

* = Non-Cancelable/Non-Returnable

Schedule 80 PVC

Flange - Van Stone (S)

3" - 12" Have CPVC Ring

150 psi @ 73°F (10.3 bar @ 22.7°C)

14" & 16" 100 psi @ 73°F (6.9 bar @ 22.7°C)

HC = Honeycomb (Front)

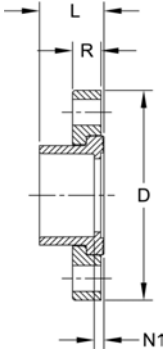

Size [inch]	P/L	Part No.	USD
½	08	854-005	17.18
¾	08	854-007	18.37
1	08	854-010	20.46
1 ¼	08	854-012	21.07
1 ½	08	854-015	21.50
2	08	854-020	28.63
2 ½	08	854-025	44.22
3	08	854-030	48.87
4	08	854-040	61.82
6	08	854-060	97.24
8	08	854-080	158.35
10	02	854-100	205.00
12	02	854-120	221.03
14	05	854-140N *	853.30
16	05	854-160N *	1141.33

Size [inch]	Pack Qty	# holes	Bolt Dia. [inch]	bolt cir. dia. [inch]	D [inch]	L [inch]	N1 [inch]	R [inch]	Design
½	5	4	½	2.38	3.50	1.03	0.11	0.57	HC
¾	5	4	½	2.75	3.88	1.15	0.13	0.58	HC
1	5	4	½	3.13	4.25	1.38	0.11	0.66	HC
1 ¼	5	4	½	3.50	4.63	1.45	0.14	0.69	HC
1 ½	5	4	½	3.88	5.00	1.59	0.15	0.76	HC
2	5	4	⅝	4.75	6.00	1.76	0.20	0.82	HC
2 ½	5	4	⅝	5.50	7.00	2.05	0.22	0.98	HC
3	5	4	⅝	6.00	7.50	2.25	0.30	1.02	HC
4	5	8	⅝	7.50	9.00	2.65	0.34	1.11	HC
6	2	8	¾	9.50	11.00	3.50	0.48	1.27	HC
8	2	8	¾	11.75	13.50	4.63	0.50	1.73	HC
10	2	12	⅞	14.25	16.00	5.63	0.50	1.73	HC
12	2	12	⅞	17.00	19.00	6.69	0.56	1.73	HC
14	1	12	1 ¼	18.75	21.00	11.75	4.75	1.00	FAB
16	1	16	1 ¼	21.25	23.50	13.50	5.50	1.00	FAB

^ = 40% Restock Charge
* = Non-Cancelable/Non-Returnable

Schedule 80 PVC

Flange - Van Stone (FPT)

3" - 12" Have CPVC Ring
 150 psi @ 73°F (10.3 bar @ 22.7°C)
 HC = Honeycomb (Front)

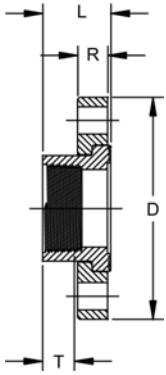

Size [inch]	P/L	Part No.	USD
½	08	855-005 ^	20.55
¾	08	855-007 ^	24.11
1	08	855-010 ^	26.37
1 ¼	08	855-012 ^	36.35
1 ½	08	855-015 ^	39.70
2	08	855-020 ^	40.62
2 ½	08	855-025 ^	93.38
3	08	855-030 ^	96.05
4	08	855-040 ^	174.64

Size [inch]	Pack Qty	# holes	Bolt Dia. [inch]	bolt cir. dia. [inch]	D [inch]	L [inch]	T [inch]	R [inch]	Design
½	5	4	½	2.38	3.50	1.03	0.53	0.57	HC
¾	5	4	½	2.75	3.88	1.15	0.55	0.58	HC
1	5	4	½	3.13	4.25	1.38	0.68	0.66	HC
1 ¼	5	4	½	3.50	4.63	1.45	0.71	0.69	HC
1 ½	5	4	½	3.88	5.00	1.59	0.72	0.76	HC
2	5	4	⅝	4.75	6.00	1.76	0.76	0.82	HC
2 ½	5	4	⅝	5.50	7.00	2.05	1.14	0.98	HC
3	5	4	⅝	6.00	7.50	2.25	1.20	1.02	HC
4	5	8	⅝	7.50	9.00	2.65	1.30	1.11	HC

Flange - Van Stone (SPG)

3" - 12" Have CPVC Ring
 150 psi @ 73°F (10.3 bar @ 22.7°C)
 HC = Honeycomb (Front)

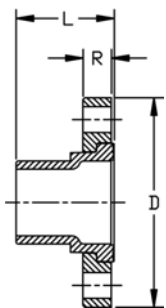
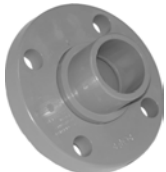

Size [inch]	P/L	Part No.	USD	Pack Qty	# holes	Bolt Dia. [inch]	bolt cir. dia. [inch]	D [inch]	L [inch]	R [inch]	Design
½	08	856-005	17.27	5	4	½	2.38	3.50	1.65	0.57	HC
¾	08	856-007	18.51	5	4	½	2.75	3.88	1.78	0.58	HC
1	08	856-010	20.63	5	4	½	3.13	4.25	2.02	0.66	HC
1 ¼	08	856-012	21.28	5	4	½	3.50	4.63	2.20	0.69	HC
1 ½	08	856-015	21.71	5	4	½	3.88	5.00	2.40	0.76	HC
2	08	856-020	28.85	5	4	⅝	4.75	6.00	2.72	0.82	HC
2 ½	08	856-025	44.59	5	4	⅝	5.50	7.00	3.19	0.98	HC
3	08	856-030	49.26	5	4	⅝	6.00	7.50	3.52	1.02	HC
4	08	856-040	62.33	5	8	⅝	7.50	9.00	4.02	1.11	HC
6	08	856-060	98.04	2	8	¾	9.50	11.00	5.00	1.37	HC
8	08	856-080	175.38	1	8	¾	11.75	13.50	6.85	1.73	HC
10	02	856-100	205.00	1	12	⅞	14.25	16.00	8.33	1.73	HC
12	02	856-120	221.03	1	12	⅞	17.00	19.00	9.54	1.73	HC

^ = 40% Restock Charge
 * = Non-Cancelable/Non-Returnable

Schedule 80 PVC

Nipple (MPT x MPT)

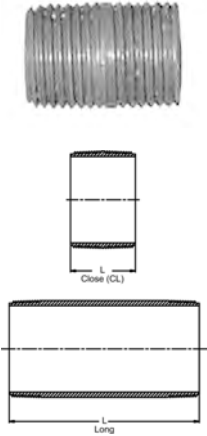

Size	P/L	Part No.	USD	Pack Qty	L [inch]
1/2 x CL	08	861-077 *	2.73	50	1.13
1/2 x 2	08	861-079 *	2.89	50	2.00
1/2 x 3	08	861-081 *	3.37	50	3.00
1/2 x 4	08	861-082 *	3.68	50	4.00
1/2 x 5	08	861-083 *	4.47	50	5.00
1/2 x 6	08	861-084 *	4.78	50	6.00
1/2 x 8	08	861-086 *	5.62	50	8.00
1/2 x 10	08	861-087 *	6.56	50	10.00
1/2 x 12	08	861-088 *	7.46	50	12.00
3/4 x CL	08	861-104 *	2.89	25	1.38
3/4 x 2	08	861-020 *	3.10	25	2.00
3/4 x 3	08	861-106 *	3.48	25	3.00
3/4 x 4	08	861-107 *	4.16	25	4.00
3/4 x 5	08	861-108 *	4.93	25	5.00
3/4 x 6	08	861-109 *	5.84	25	6.00
3/4 x 8	08	861-110 *	6.78	25	8.00
3/4 x 10	08	861-111 *	8.04	25	10.00
3/4 x 12	08	861-112 *	9.14	25	12.00
1 x CL	08	861-133 *	4.16	25	1.50
1 x 2	08	861-134 *	4.66	25	2.00
1 x 3	08	861-135 *	5.15	25	3.00
1 x 4	08	861-136 *	5.99	25	4.00
1 x 5	08	861-137 *	7.46	25	5.00
1 x 6	08	861-138 *	8.19	25	6.00
1 x 8	08	861-139 *	9.73	25	8.00
1 x 10	08	861-140 *	11.63	25	10.00
1 x 12	08	861-141 *	12.93	25	12.00
1 1/4 x CL	08	861-170 *	5.26	25	1.63
1 1/4 x 2	08	861-171 *	6.02	25	2.00
1 1/4 x 3	08	861-172 *	6.78	25	3.00
1 1/4 x 4	08	861-173 *	7.93	25	4.00
1 1/4 x 5	08	861-174 *	9.36	25	5.00
1 1/4 x 6	08	861-175 *	10.24	25	6.00
1 1/4 x 8	08	861-176 *	12.46	25	8.00
1 1/4 x 10	08	861-177 *	14.46	25	10.00
1 1/4 x 12	08	861-178 *	16.25	25	12.00
1 1/2 x CL	08	861-213 *	6.56	25	1.75
1 1/2 x 2	08	861-214 *	7.09	25	2.00
1 1/2 x 3	08	861-215 *	8.19	25	3.00
1 1/2 x 4	08	861-216 *	9.47	25	4.00
1 1/2 x 5	08	861-217 *	10.92	25	5.00
1 1/2 x 6	08	861-218 *	12.46	25	6.00
1 1/2 x 8	08	861-219 *	14.82	25	8.00
1 1/2 x 10	08	861-220 *	17.13	25	10.00
1 1/2 x 12	08	861-221 *	18.40	25	12.00
2 x CL	08	861-251 *	8.68	25	2.00
2 x 2 1/2	08	861-252 *	9.31	25	2.50
2 x 3	08	861-253 *	10.24	25	3.00
2 x 4	08	861-254 *	11.98	25	4.00
2 x 5	08	861-255 *	14.03	25	5.00
2 x 6	08	861-256 *	15.72	25	6.00
2 x 8	08	861-257 *	19.18	25	8.00
2 x 10	08	861-258 *	22.70	25	10.00
2 x 12	08	861-259 *	25.96	25	12.00
2 1/2 x CL	08	861-291 *	26.45	5	2.50

table continued next page

^ = 40% Restock Charge
 * = Non-Cancelable/Non-Returnable

Schedule 80 PVC

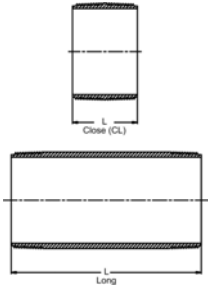

Size	P/L	Part No.	USD	Pack Qty	L [inch]
2 1/2 x 3	08	861-292 *	30.47	5	3.00
2 1/2 x 4	08	861-295 *	34.43	5	4.00
2 1/2 x 5	08	861-296 *	38.90	5	5.00
2 1/2 x 6	08	861-297 *	43.59	5	6.00
2 1/2 x 8	08	861-298 *	52.84	5	8.00
2 1/2 x 10	08	861-299 *	61.93	5	10.00
2 1/2 x 12	08	861-300 *	71.18	5	12.00
3 x CL	08	861-338 *	31.64	5	2.63
3 x 3	08	861-340 *	35.21	5	3.00
3 x 4	08	861-341 *	40.26	5	4.00
3 x 5	08	861-342 *	46.00	5	5.00
3 x 6	08	861-343 *	51.67	5	6.00
3 x 8	08	861-344 *	63.19	5	8.00
3 x 10	08	861-345 *	74.70	5	10.00
3 x 12	08	861-346 *	86.15	5	12.00
4 x CL	08	861-422 *	51.93	5	2.88
4 x 4	08	861-423 *	54.66	5	4.00
4 x 5	08	861-425 *	60.83	5	5.00
4 x 6	08	861-426 *	67.70	5	6.00
4 x 8	08	861-427 *	82.17	5	8.00
4 x 10	08	861-428 *	97.57	5	10.00
4 x 12	08	861-429 *	112.50	5	12.00

45° Wye (S x S x S)



1-1/2" - 2" 235 psi @ 72°F (16.2 bar @ 22.7°C)
 3" - 6" 150 psi @ 72°F (10.3 bar @ 22.7°C)
 8" & Larger 100 psi @ 72°F (6.9 bar @ 22.7°C)

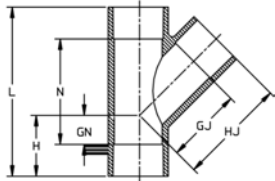

Size [inch]	P/L	Part No.	USD
1 1/2	08	870-015 *	33.52
2	08	870-020	96.16
3	08	870-030	309.11
4	08	870-040	383.01
6	08	870-060	523.13
8	08	870-080 *	1052.03
10	05	875-100N *	1272.04
12	05	875-120N *	1616.81
14	05	875-140N *	2700.31
16	05	875-160N *	3547.19

Size [inch]	Pack Qty	GJ [inch]	GN [inch]	H [inch]	HJ [inch]	L [inch]	N [inch]	Design
1 1/2	20	2.41	0.69	2.06	3.75	5.81	3.06	SL
2	10	3.61	1.38	2.89	5.16	8.05	5.00	SL
3	4	4.85	1.91	3.81	6.75	10.46	6.65	SL
4	4	6.38	1.84	4.20	8.75	12.96	8.25	SL
6	2	8.50	1.81	4.86	11.59	16.50	10.39	HS
8	1	11.06	2.06	6.06	15.25	21.25	13.31	SL
10	1	19.75	5.50	10.50	24.75	31.75	21.75	FAB
12	1	22.75	6.50	12.50	28.75	37.50	25.50	FAB
14	1	26.00	7.00	14.00	33.00	41.75	27.75	FAB
16	1	29.00	7.75	15.75	37.00	47.25	31.25	FAB

^ = 40% Restock Charge
 * = Non-Cancelable/Non-Returnable

Schedule 80 PVC

Reducing 45° Wye (S x S x S)

2" 235 psi @ 72°F (16.2 bar @ 22.7°C)

3" - 6" 150 psi @ 72°F (10.3 bar @ 22.7°C)

8" 100 psi @ 72°F (6.9 bar @ 22.7°C)

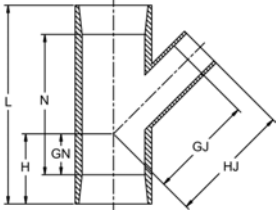

Size [inch]	P/L	Part No.	USD
2 x 1 ½	08	870-251FB *	114.39
3 x 1 ½	08	870-337FB *	360.31
3 x 2	08	870-338FB *	360.31
4 x 2	08	870-420FB *	452.99
4 x 3	08	870-422FB *	452.99
6 x 3	08	870-530FB *	493.23
6 x 4	08	870-532	398.68
8 x 4	08	870-582FB *	1376.22
8 x 6	08	870-585FB *	1283.76

Size [inch]	Pack Qty	GJ [inch]	GN [inch]	H [inch]	HJ [inch]	L [inch]	N [inch]	Design
2 x 1 ½	10	4.01	1.38	2.89	5.41	8.05	5.00	BUSH
3 x 1 ½	4	5.77	1.66	3.55	7.28	10.46	6.63	BUSH
3 x 2	4	5.72	1.66	3.55	7.28	10.46	6.63	BUSH
4 x 2	4	7.53	1.84	4.20	9.10	12.96	8.25	BUSH
4 x 3	4	7.15	1.84	4.20	9.14	12.96	8.25	BUSH
6 x 3	2	9.95	1.87	4.91	12.09	16.50	10.39	BUSH
6 x 4	2	7.18	1.87	4.91	9.45	16.50	10.39	HS
8 x 4	1	13.96	2.06	6.06	16.21	21.25	13.31	BUSH
8 x 6	1	12.62	2.06	6.06	15.72	21.25	13.31	BUSH

^ = 40% Restock Charge
* = Non-Cancelable/Non-Returnable

Schedule 80 PVC

Union Type 375 (S x S)

--Available Q2 2011--
150 psi @ 73°F (10.3 bar @ 22.7°C)

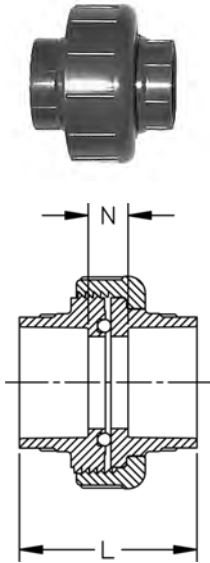

Size [inch]	P/L	EPDM Part No.	USD	FPM Part No.	USD	Pack Qty	L [inch]	N [inch]
1/2	08	897-375-005	11.48	857-375-005	11.65	25	2.16	0.41
3/4	08	897-375-007	14.61	857-375-007	14.80	10	2.44	0.43
1	08	897-375-010	16.72	857-375-010	16.88	5	2.66	0.53
1 1/4	08	897-375-012	33.15	857-375-012	33.54	5	2.98	0.50
1 1/2	08	897-375-015	37.51	857-375-015	37.99	5	3.28	0.56
2	08	897-375-020	50.89	857-375-020	51.50	2	3.53	0.57

Union Type 375 (FPT X FPT)

--Available Q2 2011--
150 psi @ 73°F (10.3 bar @ 22.7°C)

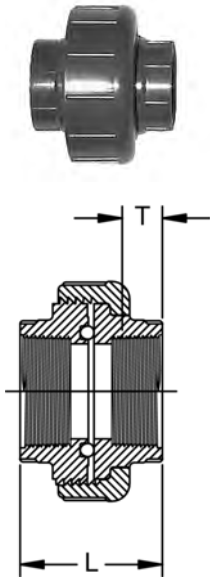

Size [inch]	P/L	EPDM Part No.	USD	FPM Part No.	USD	Pack Qty	L [inch]	T [inch]
1/2	08	898-375-005	13.50	858-375-005	13.34	25	2.03	0.53
3/4	08	898-375-007	18.91	858-375-007	18.66	10	2.11	0.55
1	08	898-375-010	25.16	858-375-010	24.85	5	2.56	0.68
1 1/4	08	898-375-012	48.00	858-375-012	47.40	5	2.79	0.71
1 1/2	08	898-375-015	59.44	858-375-015	58.69	5	2.72	0.72
2	08	898-375-020	91.45	858-375-020	90.31	2	2.89	0.76

^ = 40% Restock Charge
* = Non-Cancelable/Non-Returnable

Schedule 80 PVC

Union (S x S)

To be DISCONTINUED in 2012
150 psi @ 73°F (10.3 bar @ 22.7°C)

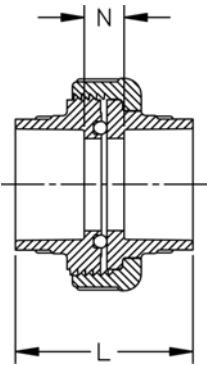

Size [inch]	P/L	EPDM Part No.	USD	FPM Part No.	USD	Pack Qty	L [inch]	N [inch]
¼	08	897-002 *	22.72	857-002 *	21.76	25	1.61	0.31
⅜	08	897-003 *	22.72	857-003 *	21.76	25	1.91	0.35
½	08	897-005 *	11.48	857-005 *	11.65	25	2.31	0.56
¾	08	897-007 *	14.61	857-007 *	14.80	10	2.62	0.57
1	08	897-010 *	16.72	857-010 *	16.88	5	2.91	0.62
1 ¼	08	897-012 *	33.15	857-012 *	33.54	5	3.25	0.64
1 ½	08	897-015 *	37.51	857-015 *	37.99	5	3.38	0.70
2	08	897-020 *	50.89	857-020 *	51.50	2	3.81	0.77
3	08	897-030 *	94.70	857-030 *	95.89	1	4.75	0.99
4	08	897-040 *	130.99	857-040 *	133.56	1	5.72	1.14

Union (FPT X FPT)

To be DISCONTINUED in 2012
150 psi @ 73°F (10.3 bar @ 22.7°C)

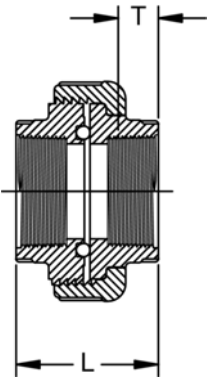

Size [inch]	P/L	EPDM Part No.	USD	FPM Part No.	USD	Pack Qty	L [inch]	T [inch]
¼	08	898-002 *	24.50	858-002 *	23.44	25	1.63	0.40
⅜	08	898-003 *	24.50	858-003 *	23.44	25	1.58	0.41
½	08	898-005 *	13.34	858-005 *	13.50	25	2.03	0.53
¾	08	898-007 *	18.66	858-007 *	18.91	10	2.11	0.55
1	08	898-010 *	24.85	858-010 *	25.16	5	2.56	0.68
1 ¼	08	898-012 *	47.40	858-012 *	48.00	5	2.79	0.71
1 ½	08	898-015 *	58.69	858-015 *	59.44	5	2.72	0.72
2	08	898-020 *	90.31	858-020 *	91.45	2	2.89	0.76
3	08	898-030 *	229.10	858-030 *	231.97	1	4.69	1.20
4	08	898-040 *	267.95	858-040 *	272.63	1	5.62	1.30

^ = 40% Restock Charge
* = Non-Cancelable/Non-Returnable

Schedule 80 PVC

Schedule 80 PVC Metal Transition Fittings

PVC-to-Brass Transition Fittings (SPG x FPT)

150 psi @ 73°F (10.3 bar @ 22.7°C)



Size [inch]	P/L	Part No.	USD	Pack Qty	HL [inch]	L [inch]	T [inch]	W [inch]
½	33	878-005BR	23.72	25	1.02	1.76	0.53	1.25
¾	33	878-007BR	34.07	15	1.09	2.08	0.55	1.50
1	33	878-010BR	58.71	15	1.33	2.45	0.68	1.88
1 ¼	33	878-012BR	96.68	15	1.39	2.51	0.71	2.25
1 ½	33	878-015BR	127.01	10	1.45	2.76	0.72	2.56
2	33	878-020BR	157.31	5	1.44	2.82	0.76	3.31

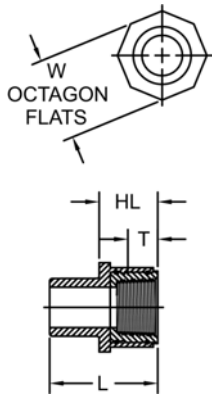

PVC-to-316 SS Transition Fittings (SPG x FPT)

150 psi @ 73°F (10.3 bar @ 22.7°C)

Size [inch]	P/L	Part No.	USD	Pack Qty	HL [inch]	L [inch]	T [inch]	W [inch]
½	33	878-005SS	46.48	25	1.02	1.76	0.53	1.25
¾	33	878-007SS	66.80	15	1.09	2.08	0.55	1.50
1	33	878-010SS	113.67	15	1.33	2.45	0.68	1.88
1 ¼	33	878-012SS	189.84	15	1.39	2.51	0.71	2.25
1 ½	33	878-015SS	247.99	10	1.45	2.76	0.72	2.56
2	33	878-020SS	318.13	5	1.44	2.82	0.76	3.31

^ = 40% Restock Charge
* = Non-Cancelable/Non-Returnable

Schedule 80 PVC

Metal Union End Connectors Type 375 (316 SS)



--Available Q2 2011--
 150 psi @ 73°F (10.3 bar @ 22.7°C)
 Union Sold Separately

Size [inch]	P/L	Part No.	USD	Pack Qty
½	33	1694-375-005 *	125.34	1
¾	33	1694-375-007 *	163.24	1
1	33	1694-375-010 *	184.64	1
1 ¼	33	1694-375-012 *	381.51	1
1 ½	33	1694-375-015 *	397.41	1
2	33	1694-375-020 *	599.17	1

Metal Union End Connectors (316 SS)



To be DISCONTINUED in 2012
 150 psi @ 73°F (10.3 bar @ 22.7°C)
 Union Sold Separately

Size [inch]	P/L	Part No.	USD	Pack Qty
½	33	1694-005 *	125.34	1
¾	33	1694-007 *	163.24	1
1	33	1694-010 *	184.64	1
1 ¼	33	1694-012 *	381.51	1
1 ½	33	1694-015 *	397.41	1
2	33	1694-020 *	599.17	1

^ = 40% Restock Charge
 * = Non-Cancelable/Non-Returnable

Schedule 80 PVC

Schedule 80 PVC Expansion Joints

Expansion Joint 6" Travel (S x S)

To order SxSPG add "P" to end of part number.

To order FxF add "F" to end of part number.



Size [inch]	P/L	EPDM Part No.	USD	FPM Part No.	USD	A [inch]	D [inch]	L [inch]	N [inch]
1/2	34	826-005X6 *	297.38	836-005X6 *	330.43	3.00	1.85	13.93	12.06
3/4	34	826-007X6 *	319.69	836-007X6 *	355.21	3.00	2.23	14.40	12.46
1	34	826-010X6 *	323.29	836-010X6 *	359.21	3.00	2.50	15.02	12.58
1 1/4	34	826-012X6 *	462.23	836-012X6 *	513.59	3.00	2.50	15.81	13.05
1 1/2	34	826-015X6 *	398.46	836-015X6 *	442.73	3.00	3.50	16.08	13.13
2	34	826-020X6 *	445.72	836-020X6 *	495.25	3.00	4.39	18.10	14.88
3	34	826-030X6 *	527.73	836-030X6 *	665.45	3.00	5.53	19.83	15.79
4	34	826-040X6 *	566.36	836-040X6 *	629.29	3.00	7.93	27.56	23.01
6	34	826-060X6 *	933.09	836-060X6 *	1036.76	3.00	9.97	27.88	21.75

Expansion Joint 12" Travel (S x S)

To order SxSPG add "P" to end of part number.

To order FxF add "F" to end of part number.

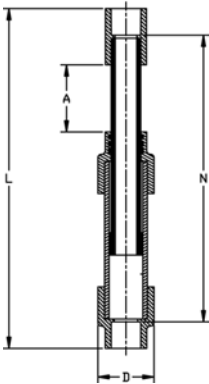

Size [inch]	P/L	EPDM Part No.	USD	FPM Part No.	USD	A [inch]	D [inch]	L [inch]	N [inch]
1/2	34	826-005X12 *	334.50	836-005X12 *	371.67	6.00	1.85	22.93	21.06
3/4	34	826-007X12 *	353.77	836-007X12 *	393.07	6.00	2.23	23.40	21.46
1	34	826-010X12 *	423.93	836-010X12 *	471.03	6.00	2.50	24.02	21.58
1 1/4	34	826-012X12 *	540.47	836-012X12 *	600.52	6.00	2.50	24.81	22.05
1 1/2	34	826-015X12 *	429.18	836-015X12 *	476.87	6.00	3.50	25.08	22.13
2	34	826-020X12 *	506.27	836-020X12 *	562.52	6.00	4.39	27.10	23.88
3	34	826-030X12 *	654.06	836-030X12 *	726.74	6.00	5.53	28.83	24.79
4	34	826-040X12 *	645.22	836-040X12 *	716.91	6.00	7.93	36.56	32.01
6	34	826-060X12 *	1070.35	836-060X12 *	1189.28	6.00	9.97	36.88	30.75

^ = 40% Restock Charge

* = Non-Cancelable/Non-Returnable

GF Piping Systems

PVC Pressure Piping System Specification Submittal Data Sheet Schedule 80 Pipe and Fittings

Pipe

Pipe will be manufactured to the dimensions and tolerances of ASTM D1785. Belled end pipe bells shall be manufactured to the dimensions and tolerances of ASTM D2672. The PVC material shall be Type I, Grade I with a cell classification of 12454 and conform to ASTM D1784. The pipe will conform to NSF 14 & 61, CSA B137.3, and UPC® standards.

- PVC Sch.80 Type I, Group I Plain End Pipe - 20 ft. Lengths
- PVC Sch.80 Type I, Group I Belled End Pipe - 20 ft. Lengths

Fittings

Socket type molded fittings will be manufactured to the dimensions and tolerances of ASTM D2467. Threaded type (NPT) molded fittings will be manufactured to the dimensions and tolerances of ASTM D2464 and meet the requirements of ANSI/ASME B 1.20.1. Flanges shall meet the O.D. and bolt hole patterns as specified in ANSI/ASME B 16.5. The PVC material shall be Type I, Grade I with a cell classification of 12454 and conform to ASTM D1784. The fittings will conform to NSF 14 & 61, and UPC® standards.

- PVC Sch.80 Type I, Grade I Socket Type
- PVC Sch.80 Type I, Grade I Threaded Type
- PVC Sch.80 Type I, Grade I Flange Type

Job Name: _____

Job Location: _____

Engineer: _____

Contractor: _____

Representative: _____



GEORG FISCHER
PIPING SYSTEMS